

Jürgen Radermacher

Dipl.-Ing.

Büro für Verkehrsingenieurbau GmbH



Project:

Alignment Engineering



Sub-Consultancy Services of Alignment Engineering for SIYAYA Consulting Engineers (Pty) Ltd. in South Africa

2014 - 2015

PRASA provided Aerial Survey Data for all Mainlines in South African Districts as Capetown, Durban, Johannesburg (Gauteng).

Based on this Aerial Survey Data a realignment of the meter gauge lines was established to raise the line speed to 120 km/h following the new alignment code.

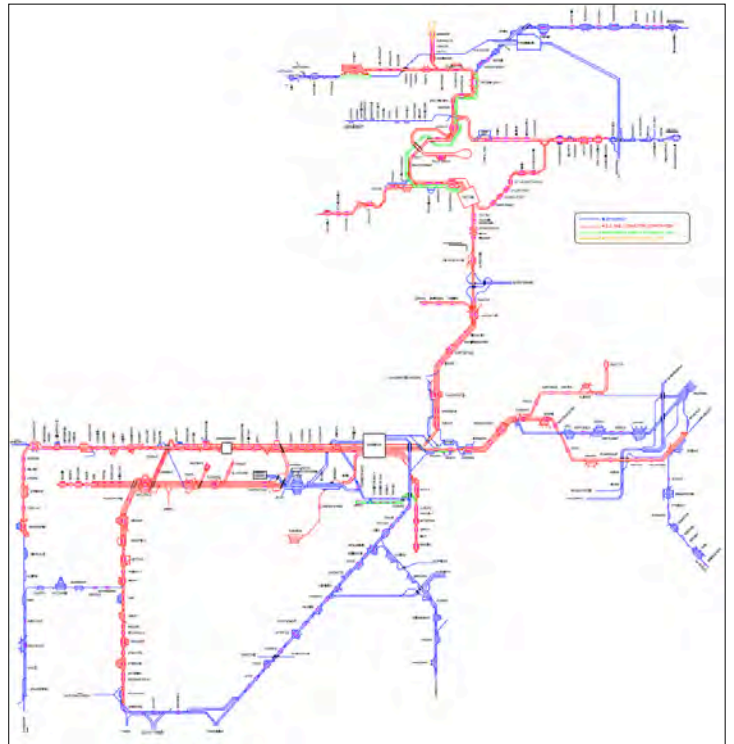

Gauteng region

- Lidar survey, approx. total length 435 km, 200m wide corridor
- Including 122 Stations

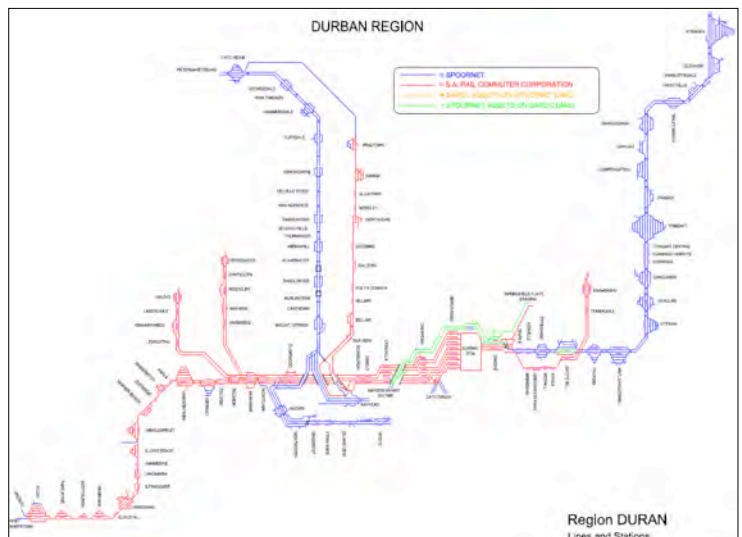
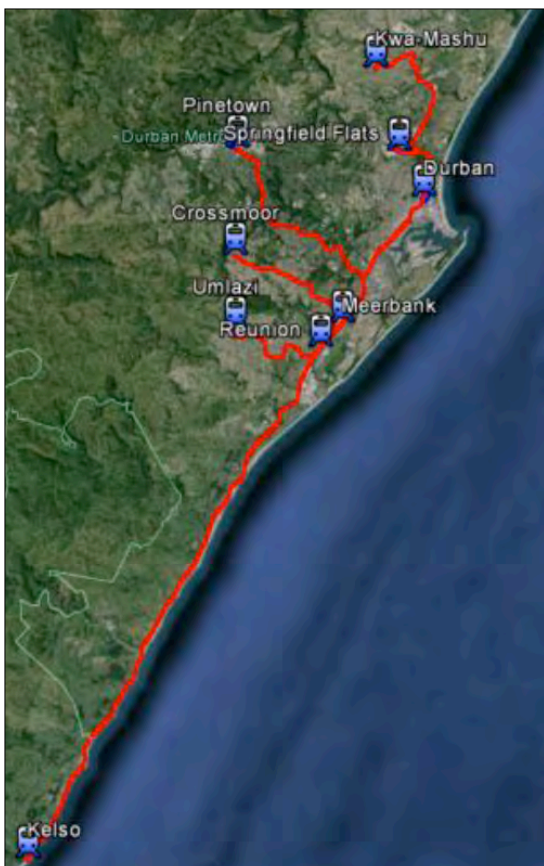

Durban region

- Lidar survey, approx. total length 130 km, 450m wide corridor
- Including 84 Stations

PRASA provided Aerial Survey Data for all Mainlines in South African Disctricts as Capetown, Durban, Johannesburg (Gauteng).

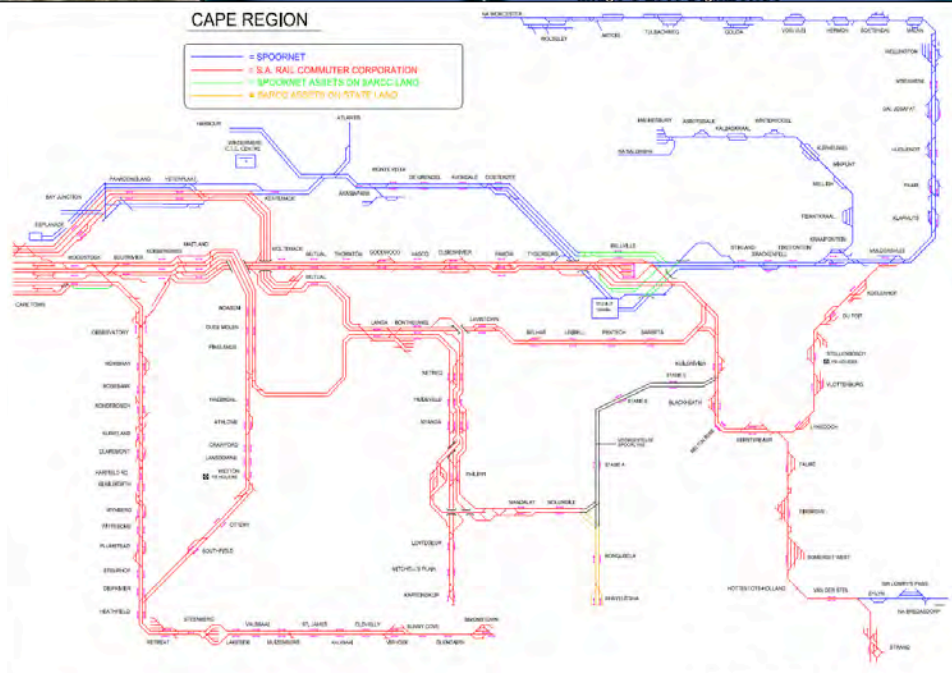

Cap region

- **Lidar survey, approx. total length 200 km, 200m wide corridor**
- **Including 131 stations**

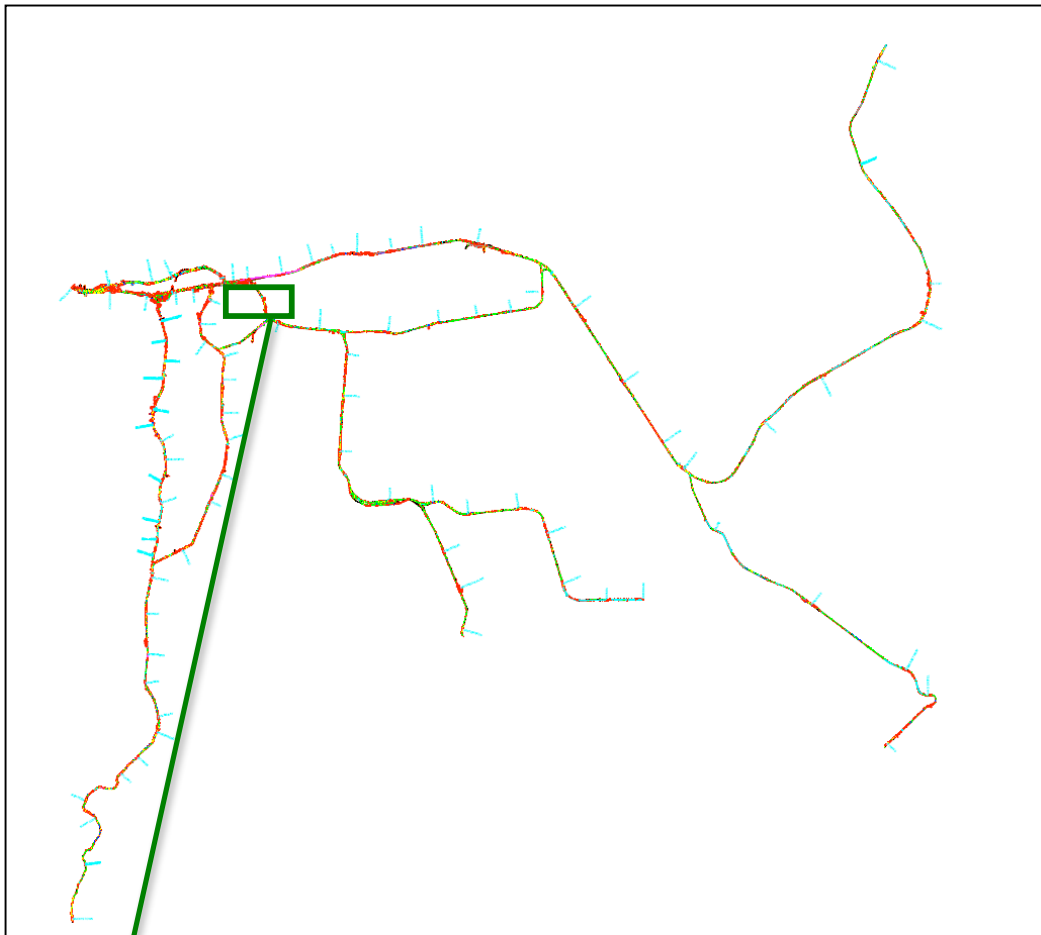

Samples of centrelines extracted from Lidar Data

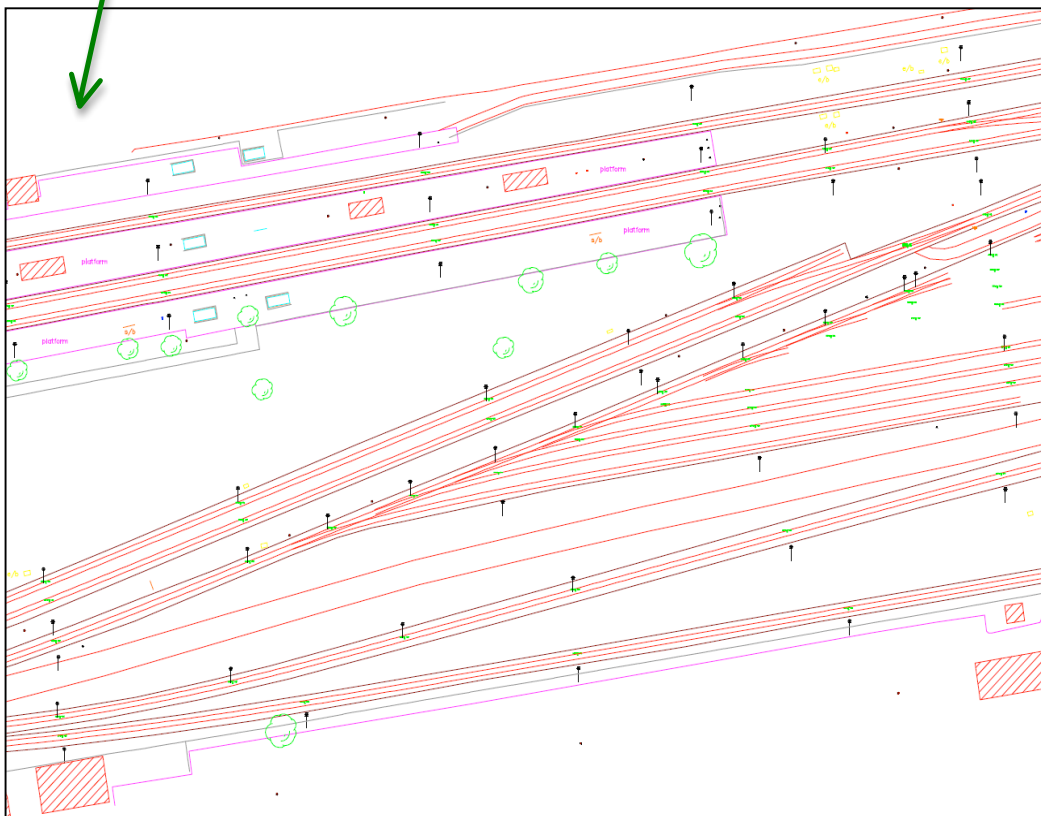

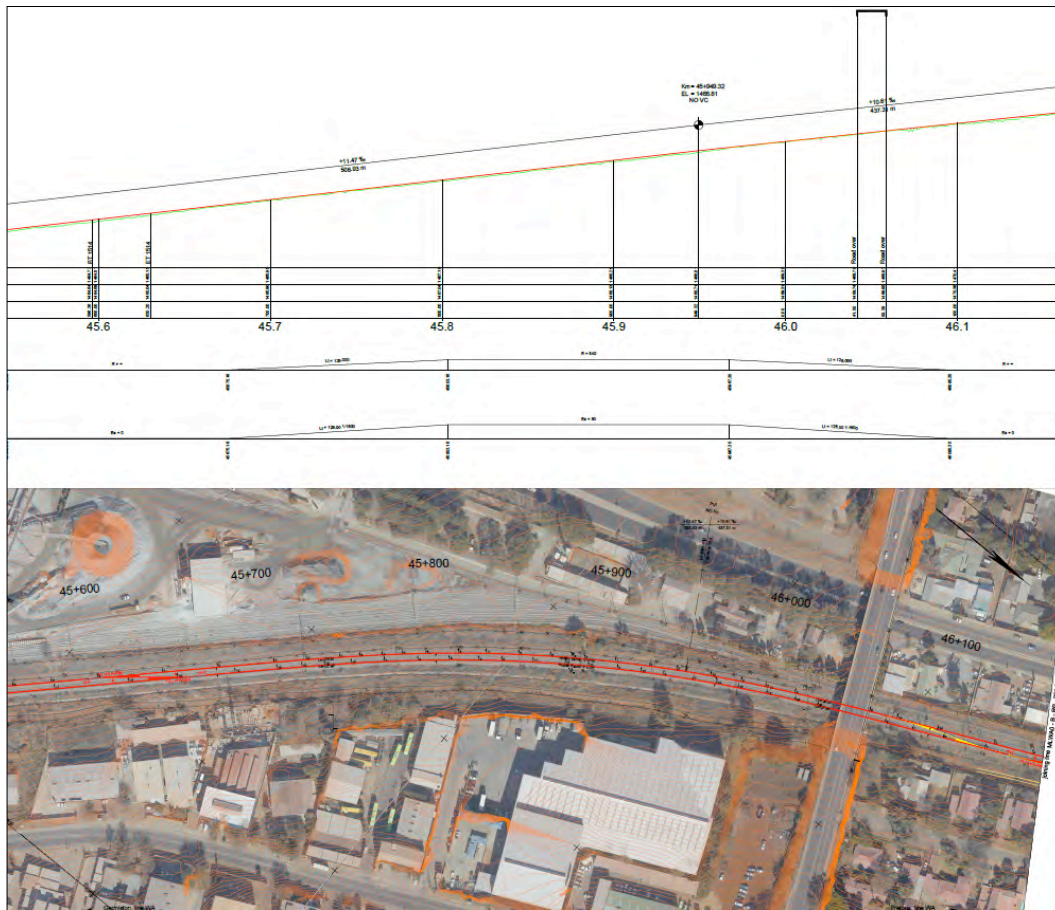

New alignment, sample of drawing (speed 120 km/h)



New alignment, sample of track displacement